



**TRANSPORTATION CABINET**

Frankfort, Kentucky 40622  
www.transportation.ky.gov/

**Steven L. Beshear**  
Governor

**Michael W. Hancock, P.E.**  
Secretary

November 10, 2011

CALL NO. 308  
CONTRACT ID NO. 111347  
ADDENDUM # 1

Subject: Hardin County, JP02 047 NEW-ROUTE  
Letting November 18, 2011

- (1) Revised - Plan Sheets - R1, R2D, R90 & R91
- (2) Added - Plan Sheet - R34a
- (3) Revised - Table of Contents - Page 2 of 97
- (4) Added - Special Note - Page 11(a) of 97
- (5) Added - Right-of-Way Certification - Pages 16(a)-16(c) of 97

Proposal revisions are available at <http://transportation.ky.gov/contract/>.  
Plan revisions are available at <http://www.lynnimaging.com/kytransportation/>.

If you have any questions, please contact us at 502-564-3500.

Sincerely,

A handwritten signature in blue ink that reads "Ryan Griffith".

Ryan Griffith  
Director  
Division of Construction Procurement

RG:ks  
Enclosures



An Equal Opportunity Employer M/F/D



# Commonwealth of Kentucky DEPARTMENT OF HIGHWAYS

## PLANS OF PROPOSED PROJECT

### NEW CONNECTOR ROUTE JP02 047 NEW-ROUTE



INDEX OF SHEETS	
SHEET NO.	DESCRIPTION
R1	LAYOUT SHEET
R2-R2m	TYPICAL SECTIONS-SUMMARY OF QUANTITIES
R3-R4I	PLAN AND PROFILE SHEETS
	UTILITY REFERENCE SHEETS
R42-R43	RIGHT OF WAY SUMMARY SHEETS
R44-R53	RIGHT OF WAY STRIP MAP SHEETS
R54	RIGHT OF WAY MONUMENTATION SHEET
R55-R60	DETAIL SHEETS
R61-R68	STRIPING PLAN SHEETS
R69-R92	TRAFFIC CONTROL SHEETS
R93-R101	EROSION CONTROL SHEETS
	MITIGATION PLAN SHEETS
R102-R109	COORDINATE CONTROL SHEETS
R110-R132	SOIL PROFILE SHEETS
R133-R165	PIPE DRAINAGE SHEETS
	STRUCTURE PLANS
	TRAFFIC PLANS
	UTILITY RELOCATION PLANS
X1-X287	CROSS SECTION SHEETS

SHEETS NOT INCLUDED IN TOTAL SHEETS  
R2a, R2b, R2c, R2d, R2e, R2f, R2g, R2h, R2i, R2j, R2k, R2l, R2m & R34a

STANDARD DRAWINGS		
NUMBER		
RBI-001-09	RDD-040-04	RPM-011-05
RBI-002-06	RDH-020-03	RPM-100-09
RBI-003-07	RDH-110-02	RPM-110-05
RBR-001-11	RDH-210-03	RRE-002-04
RBR-005-10	RDI-021	TPM-100-01
RBR-010-05	RDI-026	TPM-105-01
RBR-015-04	RDI-035-01	TPM-115-01
RBR-016-04	RDI-045-01	TPM-120-01
RBR-025-03	RDP-001-05	TPM-125-01
RBR-030-04	RDP-005-04	TPM-140-01
RBR-031	RDP-006-03	TPM-145-01
RBR-035-08	RDP-010-08	TTC-100-01
RDB-005-08	RDX-160-05	TTC-115-01
RDB-013-06	RDX-210-02	TTC-135-01
RDB-014-05	RDX-220-04	TTC-145-01
RDB-015-03	RDX-225	TTC-150-01
RDB-016-02	RDX-230	TTC-155-01
RDB-017-02	RFW-001-04	TTC-160-01
RDB-100-04	RGS-001-06	TTD-110-01
RDB-101-04	RGS-002-05	TTS-100-01
RDB-105-05	RGX-001-05	TTS-105-01
RDB-106-04	RGX-005-05	TTS-110-01
RDB-110-07	RGX-010-03	TTS-115-01
RDD-030-07	RGX-200	

TOTAL STANDARD DRAWINGS : 71

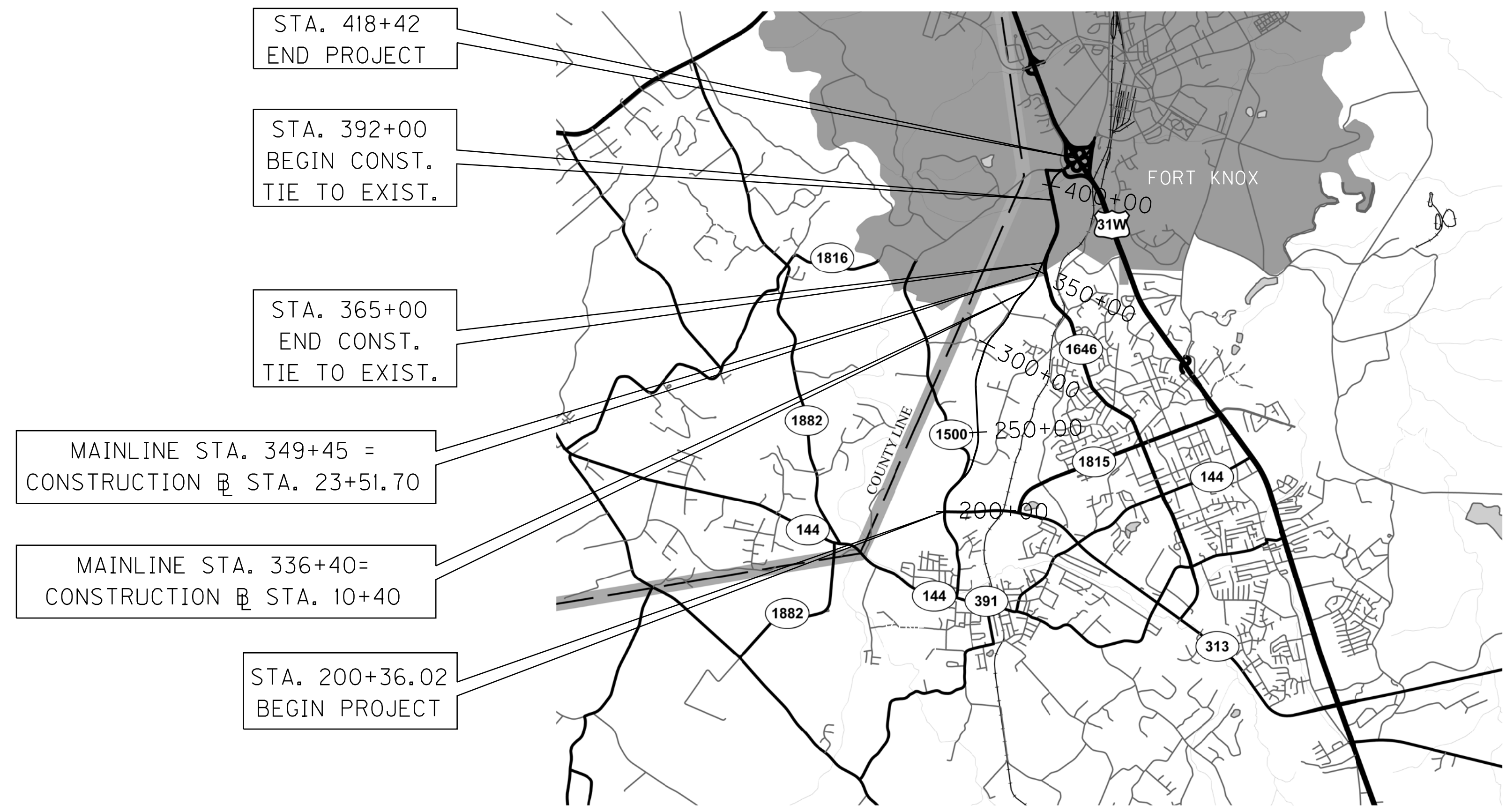

THESE PLANS ARE FOR  
GRADE, DRAIN AND SURFACING.

THIS PROJECT IS A PARTIALLY  
CONTROLLED ACCESS HIGHWAY.  
ACCESS SHALL BE PROVIDED ONLY  
WHERE SPECIFICALLY SHOWN ON  
THE PLANS. MINIMUM SPACING FOR  
ACCESS SHALL BE 1,200 FEET.

DESIGN CRITERIA	
CLASS OF HIGHWAY	RURAL COLLECTOR
TYPE OF TERRAIN	ROLLING
DESIGN SPEED	55 mph.
REQUIRED NPSD	
REQUIRED PSD	
LEVEL OF SERVICE	
ADT PRESENT ( 2008 )	10,000
ADT FUTURE ( 2030 )	18,000
DHV (2030)	2,150
D %	
T %	6%

GEOGRAPHIC COORDINATES	
LATITUDE	37 DEGREES 51 MINUTES 05 SECONDS NORTH
LONGITUDE	85 DEGREES 58 MINUTES 55 SECONDS WEST

DESIGNED	
% RESTRICTED SD	
LEVEL OF SERVICE	
MAX. DISTANCE W/O PASSING	

SCALE 1" = 5,000'  
**LAYOUT MAP**

MAINLINE			
LENGTH 19105.98 LIN. FT. 3.619 MILES	LENGTH _____ LIN. FT. _____ MILES	LENGTH _____ LIN. FT. _____ MILES	LENGTH _____ LIN. FT. _____ MILES
ADDED _____ FOR EQUALITIES _____ LIN. FT.	ADDED _____ FOR EQUALITIES _____ LIN. FT.	ADDED _____ FOR EQUALITIES _____ LIN. FT.	ADDED _____ FOR EQUALITIES _____ LIN. FT.
DEDUCTED _____ NOT INCLUDED	DEDUCTED _____ NOT INCLUDED	DEDUCTED _____ NOT INCLUDED	DEDUCTED _____ NOT INCLUDED
RAILROAD CROSSINGS NO. _____ LIN. FT.	RAILROAD CROSSINGS NO. _____ LIN. FT.	RAILROAD CROSSINGS NO. _____ LIN. FT.	RAILROAD CROSSINGS NO. _____ LIN. FT.
BRIDGES _____ LIN. FT.	BRIDGES _____ LIN. FT.	BRIDGES _____ LIN. FT.	BRIDGES _____ LIN. FT.

**Commonwealth of Kentucky  
DEPARTMENT OF HIGHWAYS  
COUNTY OF  
HARDIN**

ITEM NO. 4-8103.50  
PROJECT JP02 047 NEW-ROUTE  
NUMBER: \_\_\_\_\_  
LETTING DATE: \_\_\_\_\_

RECOMMENDED BY: JOHN MOORE DATE: 9/19/2011  
PROJECT MANAGER

PLAN APPROVED BY: \_\_\_\_\_ DATE: 10-20-2011  
STATE HIGHWAY ENGINEER

**HMB** Professional Engineers, Inc.  
3 HMB Circle  
Frankfort, KY 40601  
(502) 695-9800  
(502) 695-9810 Fax

**CLINTON D. YOUNG**  
25389  
LICENSED PROFESSIONAL ENGINEER

*Clinton D. Young*

NO. SETS	DATE

REVIEWED BY	DIVISION OF CONSTRUCTION

USER: \$\$\$USER\$\$\$  
DATE: \$\$\$DATE\$\$\$  
FILE NAME: \$\$\$designs\$file\$specifications\$\$\$  
E-SHEET NAME:



# Commonwealth of Kentucky DEPARTMENT OF HIGHWAYS

## PLANS OF PROPOSED PROJECT

### NEW CONNECTOR ROUTE JP02 047 NEW-ROUTE

COUNTY OF	ITEM NO.	SHEET NO.
HARDIN	4-8103.50	R1

REVISED 11-9-2011



NO. SETS	DATE

REVIEWED BY	DIVISION OF CONSTRUCTION

SHEET NO.	DESCRIPTION
R1	LAYOUT SHEET
R2-R2m	TYPICAL SECTIONS-SUMMARY OF QUANTITIES
R3-R4I	PLAN AND PROFILE SHEETS
R42-R43	UTILITY REFERENCE SHEETS
R44-R53	RIGHT OF WAY SUMMARY SHEETS
R54	RIGHT OF WAY STRIP MAP SHEETS
R55-R60	RIGHT OF WAY MONUMENTATION SHEET
R61-R68	DETAIL SHEETS
R69-R92	STRIPING PLAN SHEETS
R93-R101	TRAFFIC CONTROL SHEETS
R102-R109	EROSION CONTROL SHEETS
R110-R132	MITIGATION PLAN SHEETS
R133-R165	COORDINATE CONTROL SHEETS
	SOIL PROFILE SHEETS
	PIPE DRAINAGE SHEETS
	STRUCTURE PLANS
	TRAFFIC PLANS
	UTILITY RELOCATION PLANS
X1-X287	CROSS SECTION SHEETS

SHEETS NOT INCLUDED IN TOTAL SHEETS  
R2g, R2b, R2c, R2d, R2e, R2f, R2g, R2h, R2i, R2j, R2k, R2l, R2m & R34g

STANDARD DRAWINGS		
NUMBER		
RBI-001-09	RDD-040-04	RPM-011-05
RBI-002-06	RDH-020-03	RPM-100-09
RBI-003-07	RDH-110-02	RPM-110-05
RBR-001-11	RDH-210-03	RRE-002-04
RBR-005-10	RDI-021	TPM-100-01
RBR-010-05	RDI-026	TPM-105-01
RBR-015-04	RDI-035-01	TPM-115-01
RBR-016-04	RDI-045-01	TPM-120-01
RBR-025-03	RDP-001-05	TPM-125-01
RBR-030-04	RDP-005-04	TPM-140-01
RBR-031	RDP-006-03	TPM-145-01
RBR-035-08	RDP-010-08	TTC-100-01
RDB-005-08	RDX-160-05	TTC-115-01
RDB-013-06	RDX-210-02	TTC-135-01
RDB-014-05	RDX-220-04	TTC-145-01
RDB-015-03	RDX-225	TTC-150-01
RDB-016-02	RDX-230	TTC-155-01
RDB-017-02	RFW-001-04	TTC-160-01
RDB-100-04	RGS-001-06	TTD-110-01
RDB-101-04	RGS-002-05	TTS-100-01
RDB-105-05	RGX-001-05	TTS-105-01
RDB-106-04	RGX-005-05	TTS-110-01
RDB-110-07	RGX-010-03	TTS-115-01
RDD-030-07	RGX-200	

TOTAL STANDARD DRAWINGS : 71

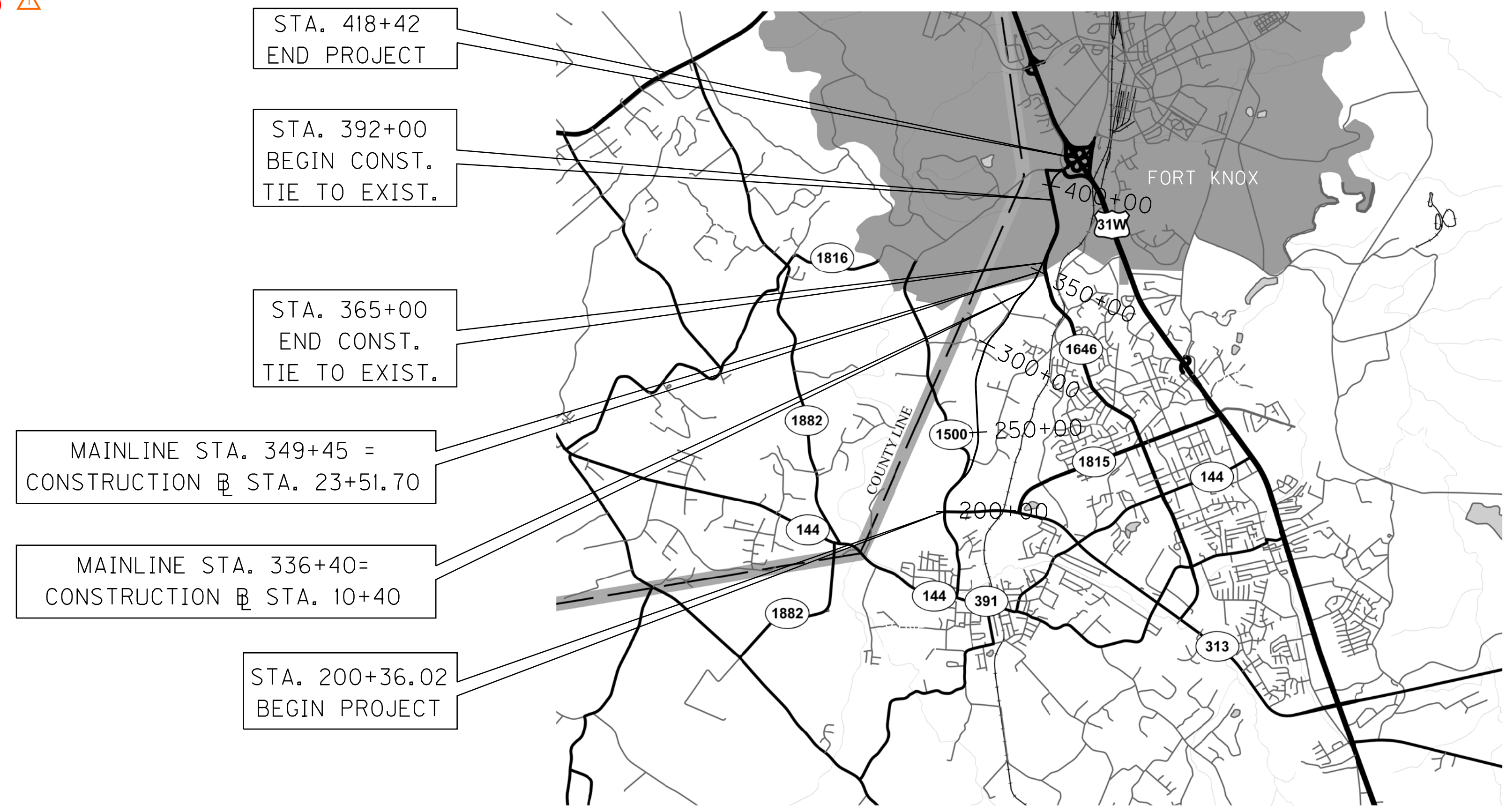

THESE PLANS ARE FOR  
GRADE, DRAIN AND SURFACING.

THIS PROJECT IS A PARTIALLY  
CONTROLLED ACCESS HIGHWAY.  
ACCESS SHALL BE PROVIDED ONLY  
WHERE SPECIFICALLY SHOWN ON  
THE PLANS. MINIMUM SPACING FOR  
ACCESS SHALL BE 1,200 FEET.

DESIGN CRITERIA	
CLASS OF HIGHWAY	RURAL COLLECTOR
TYPE OF TERRAIN	ROLLING
DESIGN SPEED	55 mph.
REQUIRED NPSD	
REQUIRED PSD	
LEVEL OF SERVICE	
ADT PRESENT ( 2008 )	10,000
ADT FUTURE ( 2030 )	18,000
DHV (2030)	2,150
D %	
T %	6%

GEOGRAPHIC COORDINATES	
LATITUDE	37 DEGREES 51 MINUTES 05 SECONDS NORTH
LONGITUDE	85 DEGREES 58 MINUTES 55 SECONDS WEST

DESIGNED	
% RESTRICTED SD	
LEVEL OF SERVICE	
MAX. DISTANCE W/O PASSING	

SCALE 1" = 5,000'

### LAYOUT MAP

MAINLINE			
LENGTH	LIN. FT.	MILES	
19105.98	3,619		
ADDED	FOR EQUALITIES		
DEDUCTED	NOT INCLUDED		
RAILROAD CROSSINGS NO.	LIN. FT.		
BRIDGES	LIN. FT.		

Commonwealth of Kentucky  
DEPARTMENT OF HIGHWAYS  
COUNTY OF  
**HARDIN**

ITEM NO. 4-8103.50  
PROJECT JP02 047 NEW-ROUTE  
NUMBER:  
LETTING DATE:

RECOMMENDED BY: JOHN MOORE DATE: 9/19/2011  
PROJECT MANAGER

PLAN APPROVED BY: [Signature] DATE: 10-20-2011  
STATE HIGHWAY ENGINEER

HMB Professional Engineers, Inc.  
3 HMB Circle  
Frankfort, KY 40601  
(502) 695-9800  
(502) 695-9810 Fax

USER: \$\$\$USER\$\$\$  
DATE: \$\$\$DATE\$\$\$  
FILE NAME: \$\$\$designs\$file\$specifications\$\$\$  
E-SHEET NAME:



# TYPICAL SECTIONS

PREPARED BY \_\_\_\_\_ DATE \_\_\_\_\_  
 CHECKED BY \_\_\_\_\_ DATE \_\_\_\_\_  
 APPROVED BY \_\_\_\_\_ DATE \_\_\_\_\_

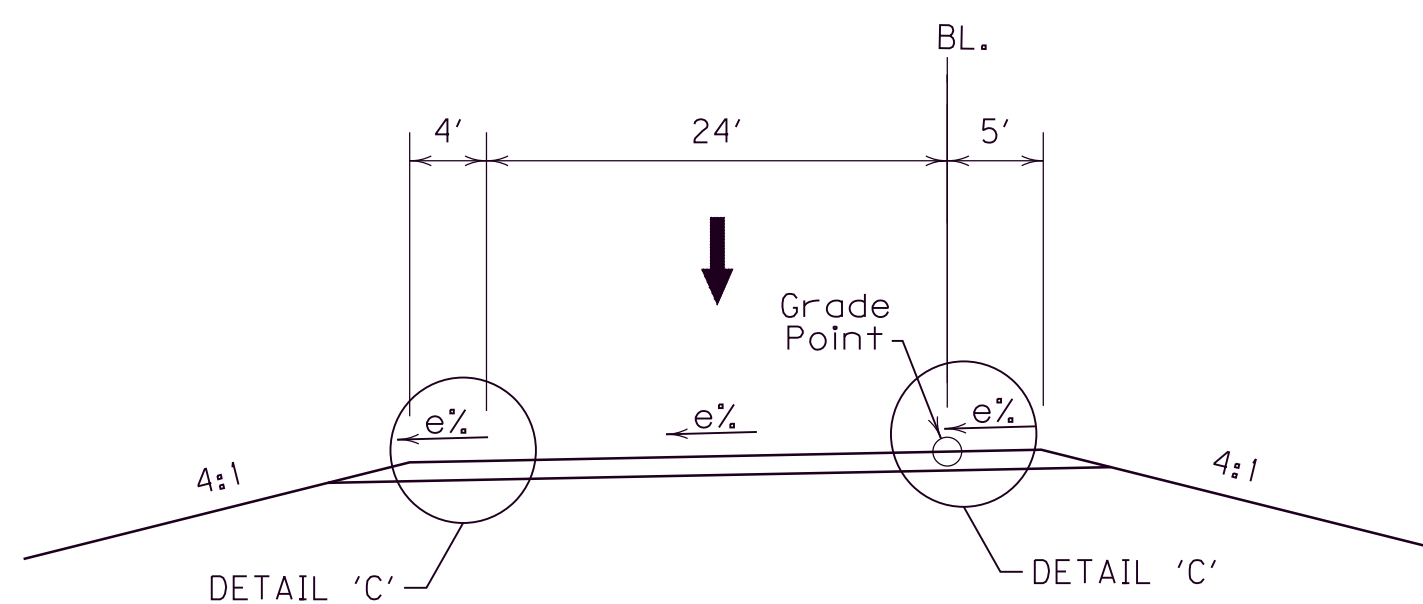

**RAMP RT. 411 + 18**

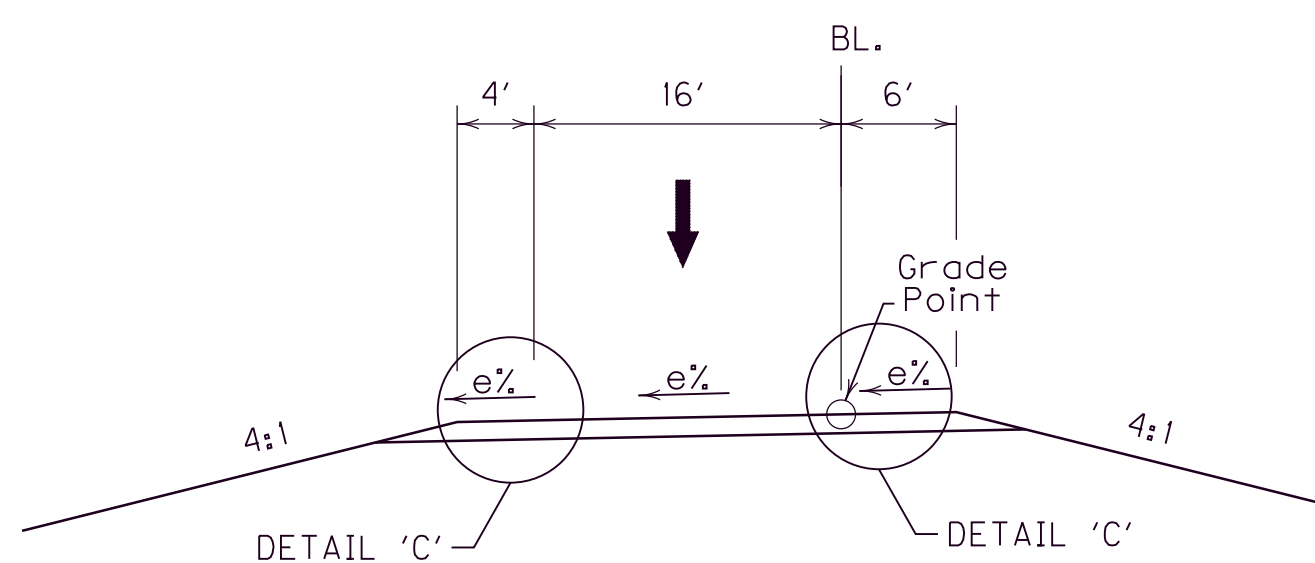

**RAMP LT. 415 + 60**

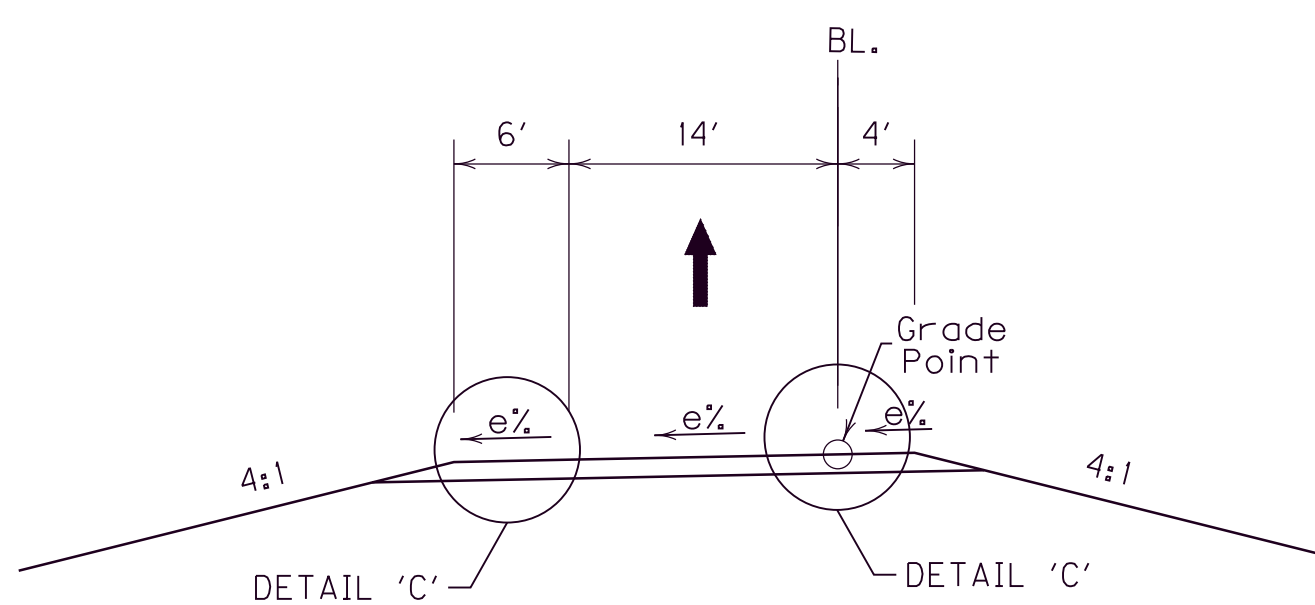

**RAMP RT. 416 + 68**

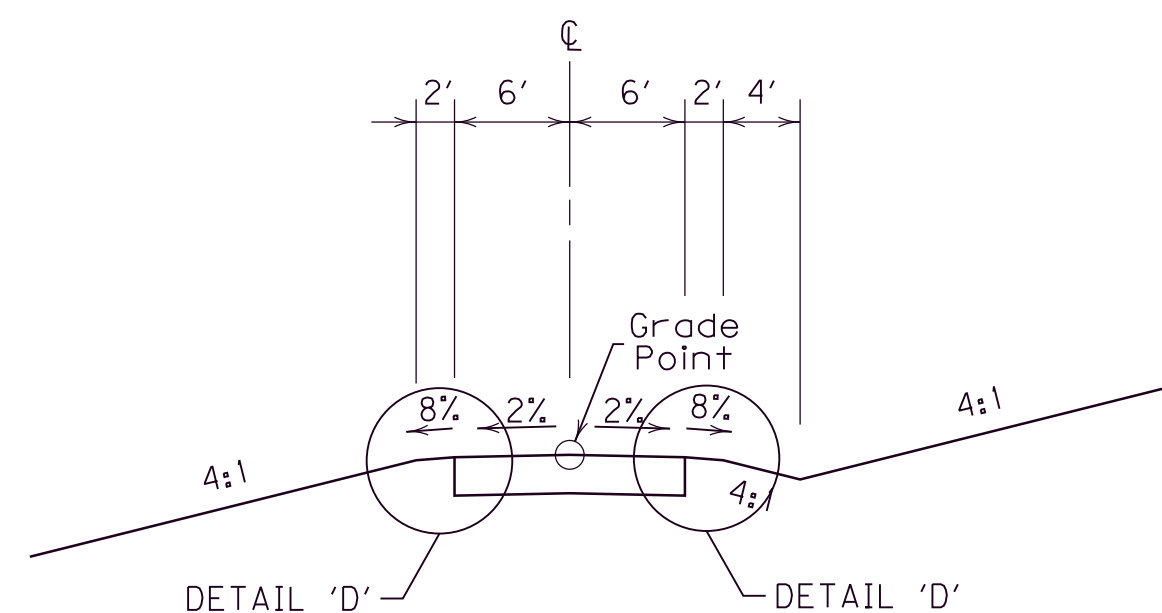

**DIVERSION No. 1 (Lt. Sta. 322 + 00)**

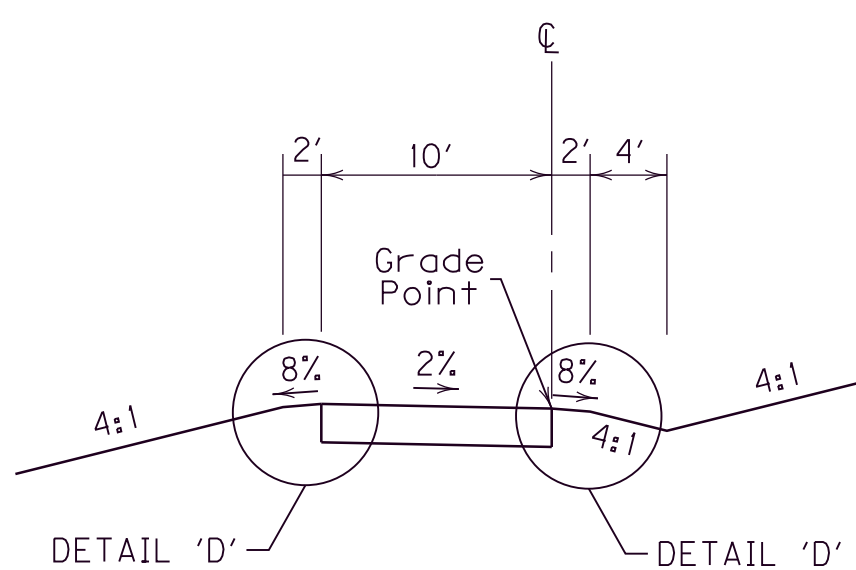

**DIVERSION No. 2 (Logsdon Pkwy. S.B. X-over)**

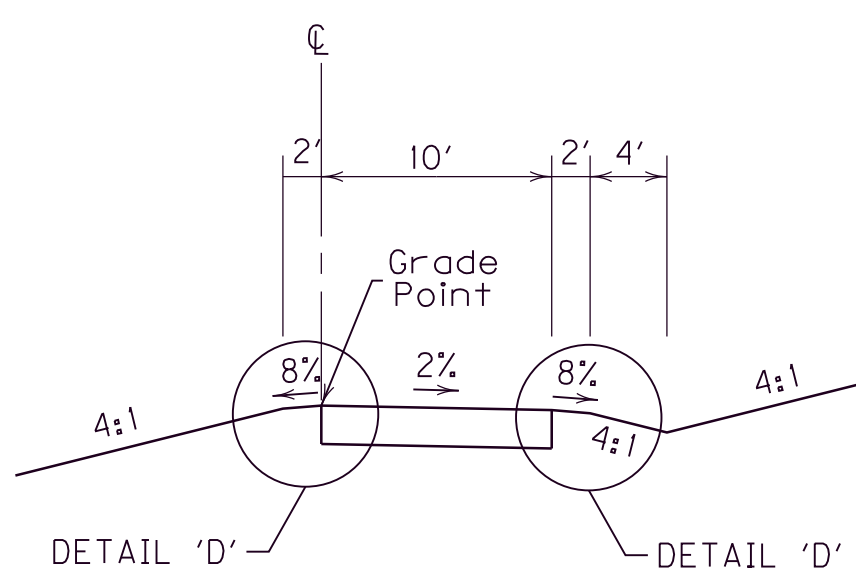

**DIVERSION No. 3 (Logsdon Pkwy. N.B. X-over)**

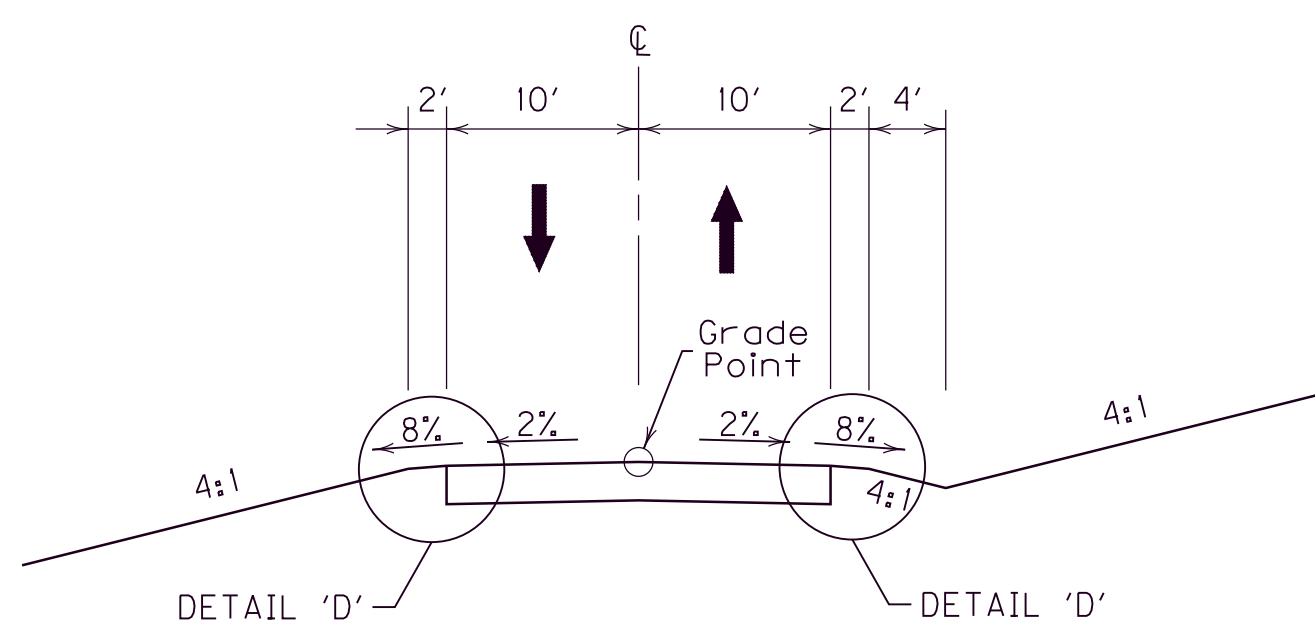

**DIVERSION No. 4 (Lt. Sta. 407 + 50)**

**DIVERSION SURFACING SCHEDULE  
DRIVING LANES**

APPROXIMATE 7" BASE — [ 4" CRUSHED STONE BASE  
3" CLASS 2 ASPHALT BASE 1.0D PG64-22

APPROXIMATE 1 1/4" SURFACE — [ 1 1/4" CLASS 2 ASPHALT SURFACE 0.38D PG64-22

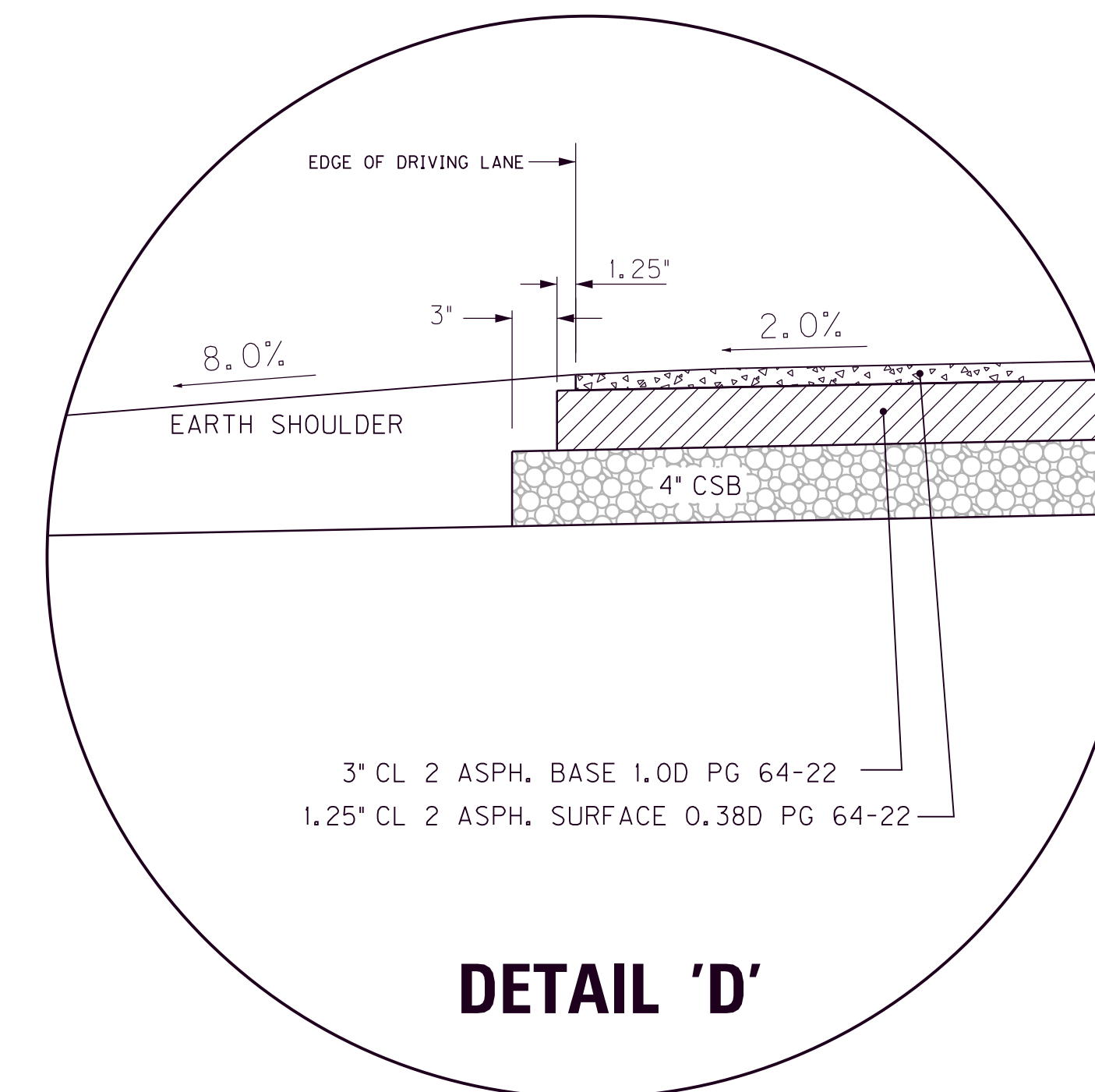

3" CL 2 ASPH. BASE 1.0D PG 64-22  
1.25" CL 2 ASPH. SURFACE 0.38D PG 64-22

**DETAIL 'D'**

NOT TO SCALE

TYPICAL SECTIONS  
RAMPS & DIVERSIONS

USER: \$\$\$USER\$\$\$  
 DATE: \$\$\$DATE\$\$\$  
 FILE NAME: \$\$\$designs\$file\$specifications\$\$\$  
 E-SHEET NAME:

△ Revised Nov 7, 2011

# TYPICAL SECTIONS

PREPARED BY \_\_\_\_\_ DATE \_\_\_\_\_  
 CHECKED BY \_\_\_\_\_ DATE \_\_\_\_\_  
 APPROVED BY \_\_\_\_\_ DATE \_\_\_\_\_

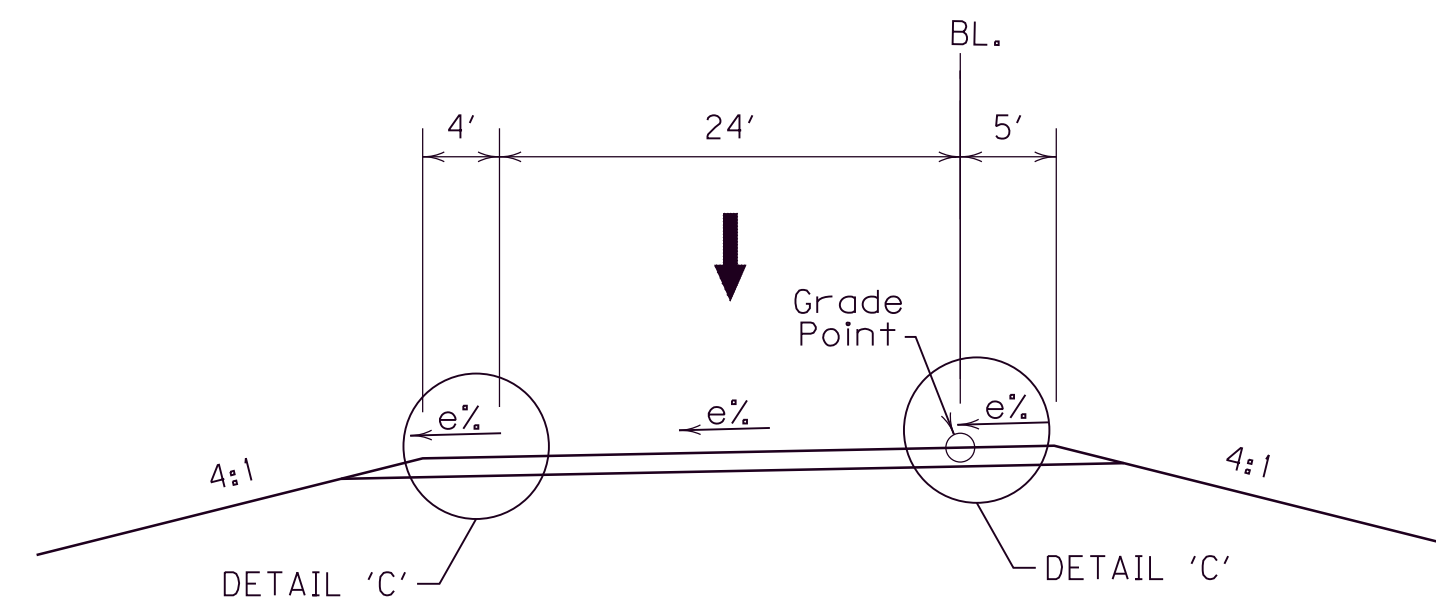

**RAMP RT. 411 + 18**

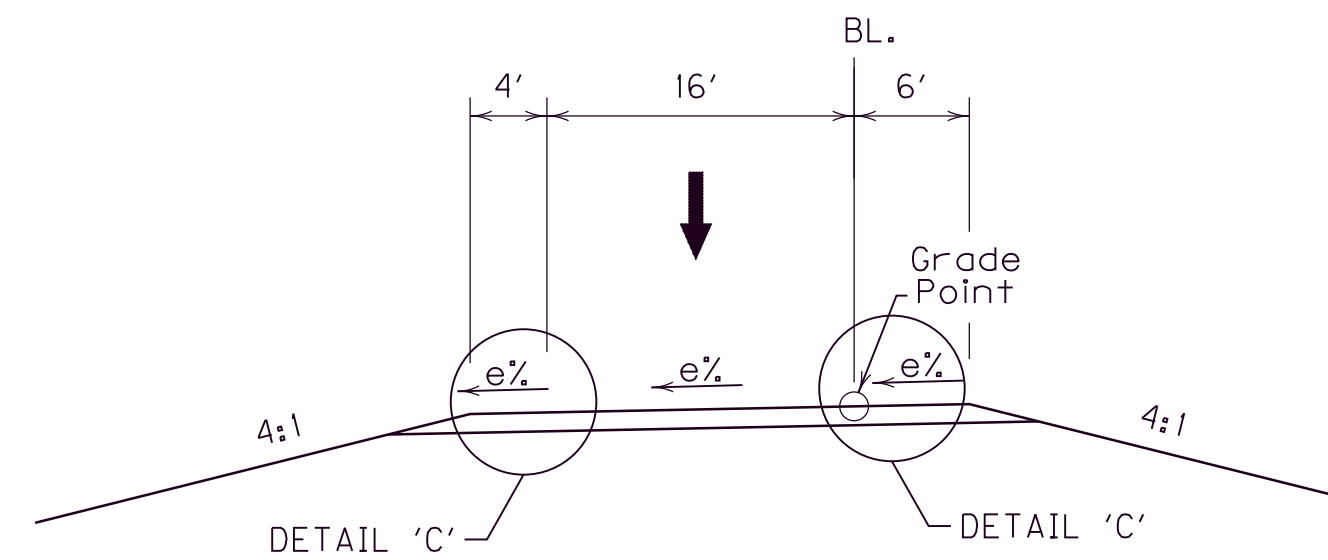

**RAMP LT. 415 + 60**

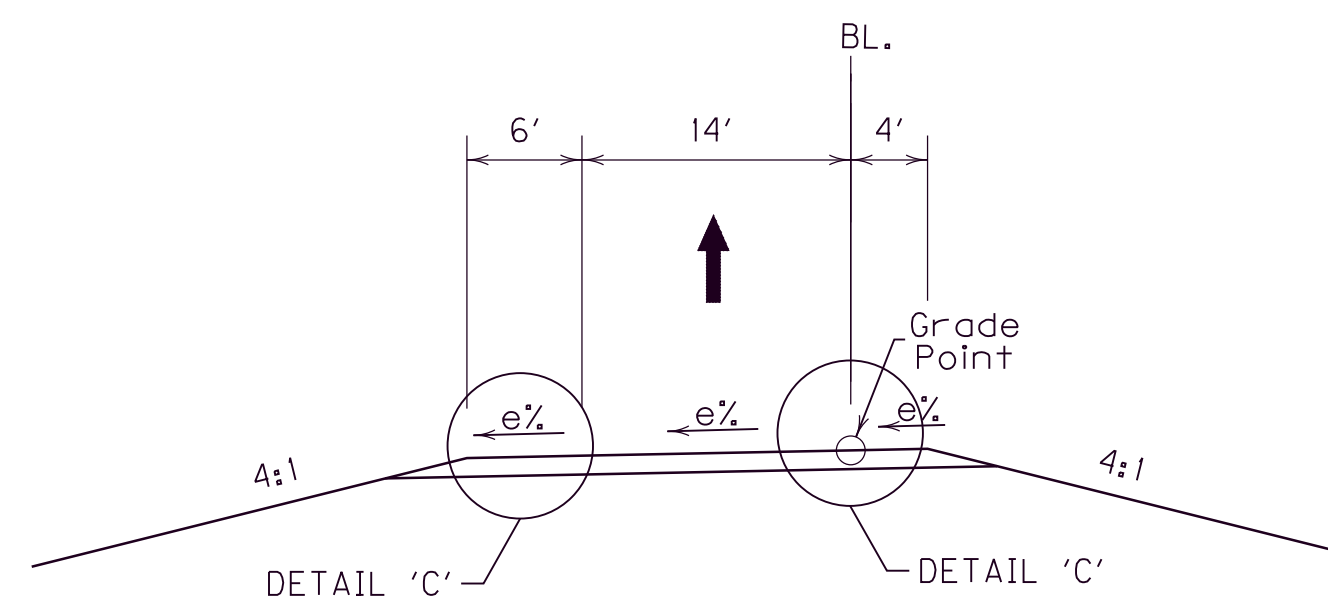

**RAMP RT. 416 + 68**

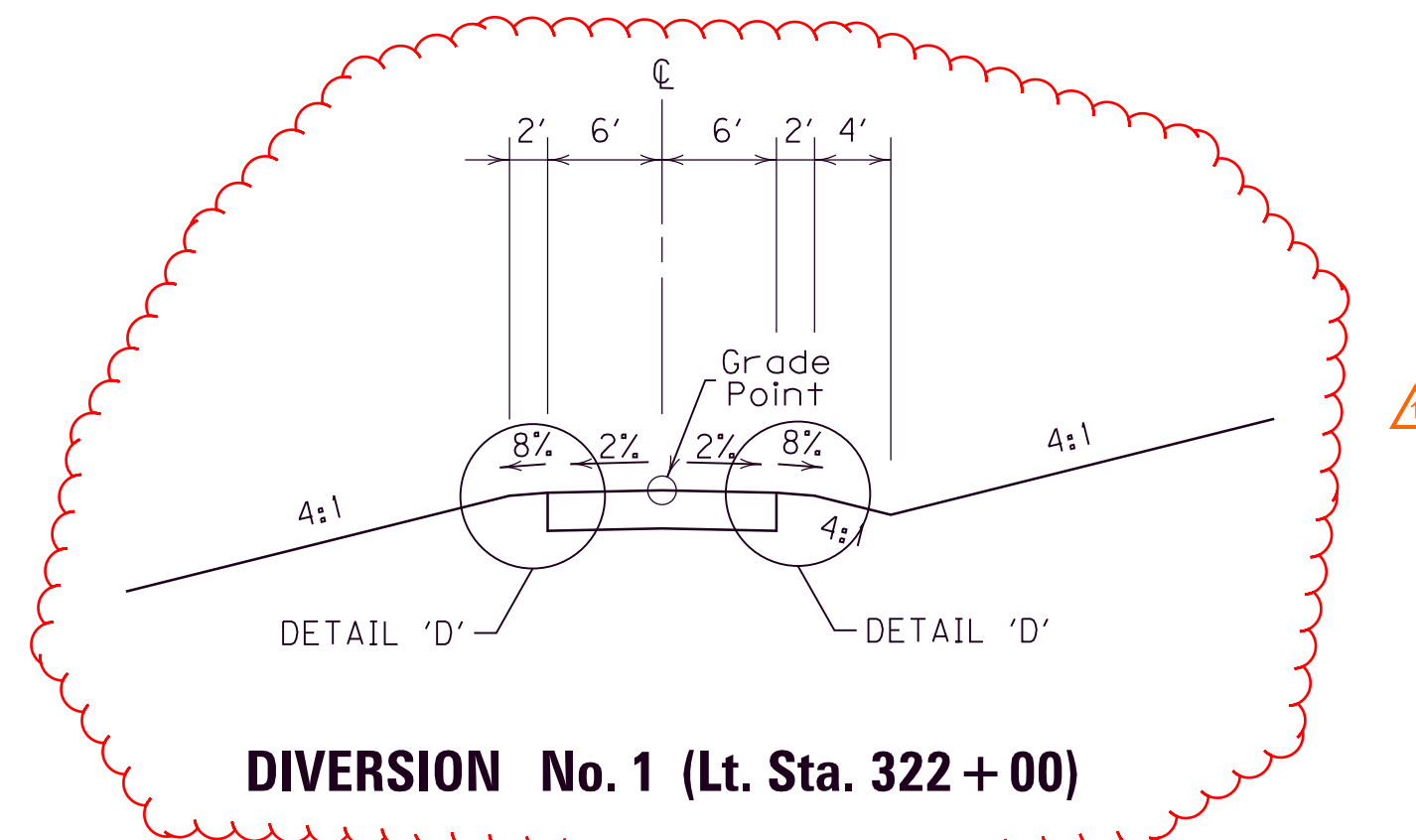

**DIVERSION No. 1 (Lt. Sta. 322 + 00)**

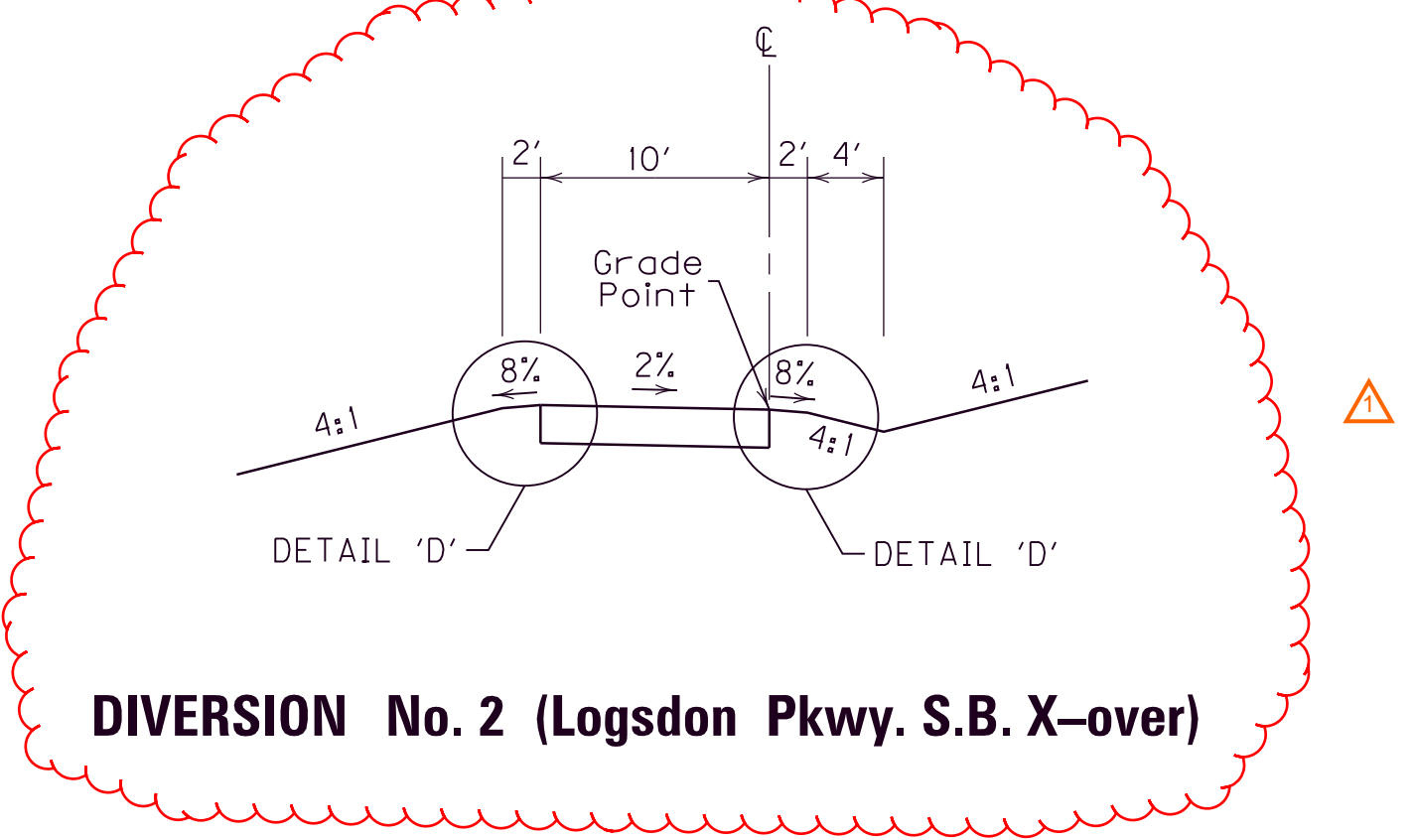

**DIVERSION No. 2 (Logsdon Pkwy. S.B. X-over)**

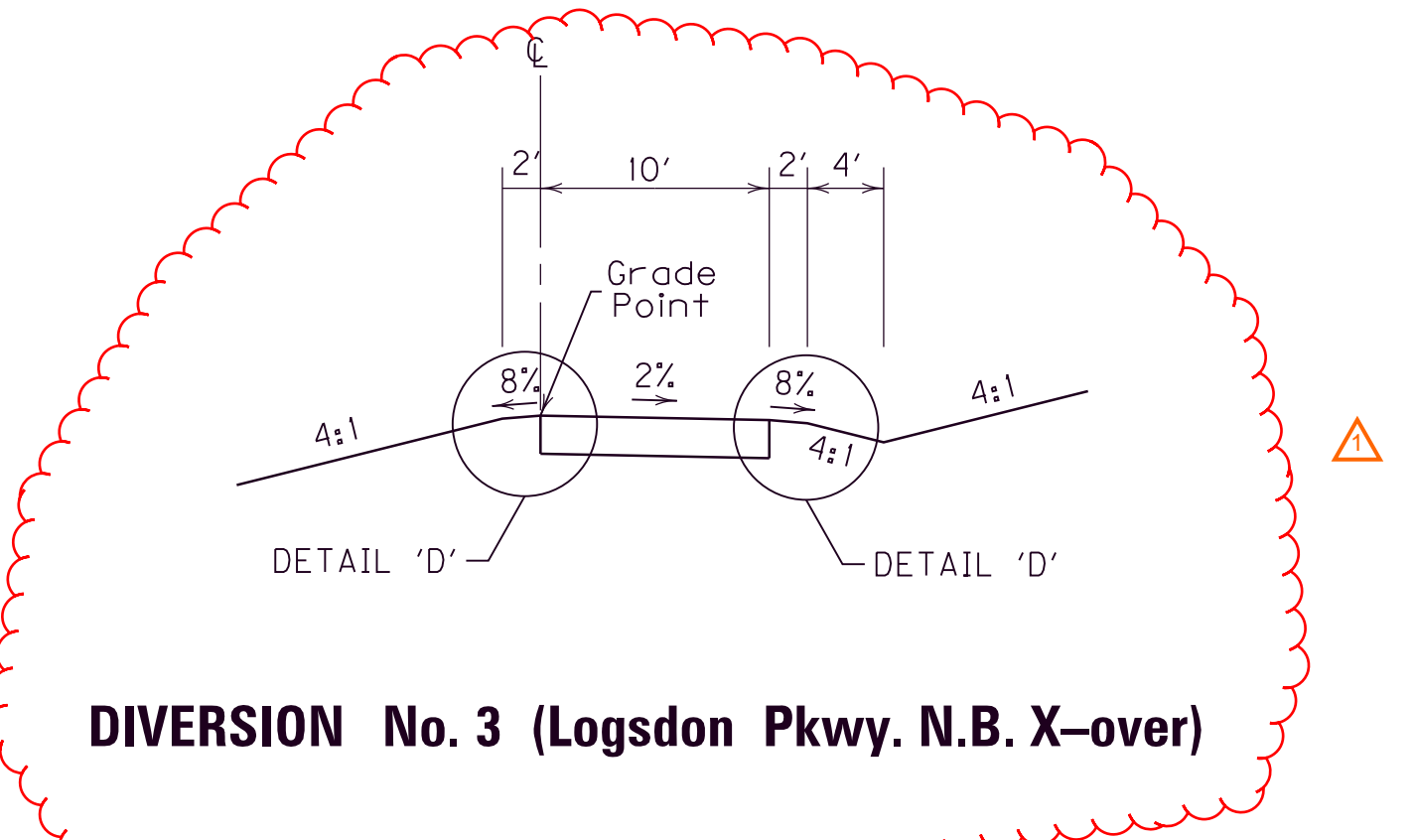

**DIVERSION No. 3 (Logsdon Pkwy. N.B. X-over)**

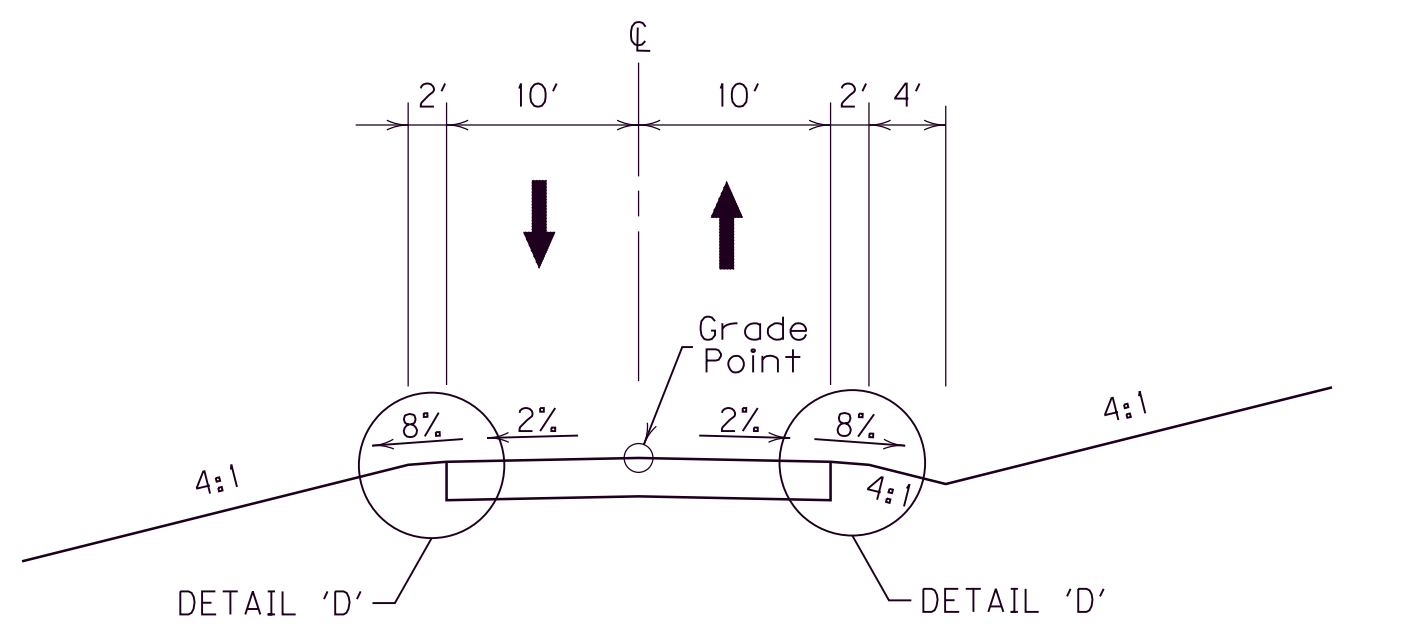

**DIVERSION No. 4 (Lt. Sta. 407 + 50)**

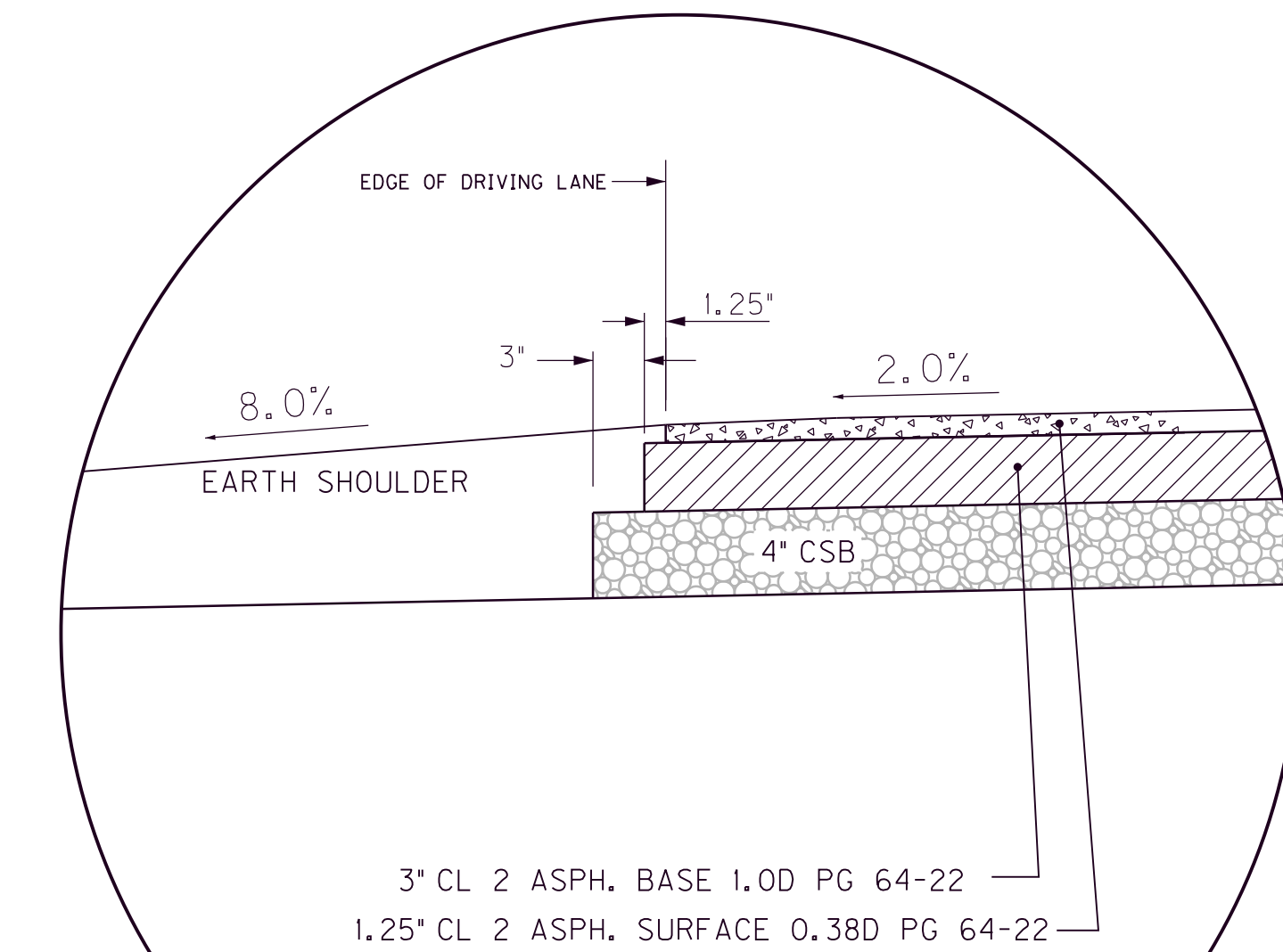
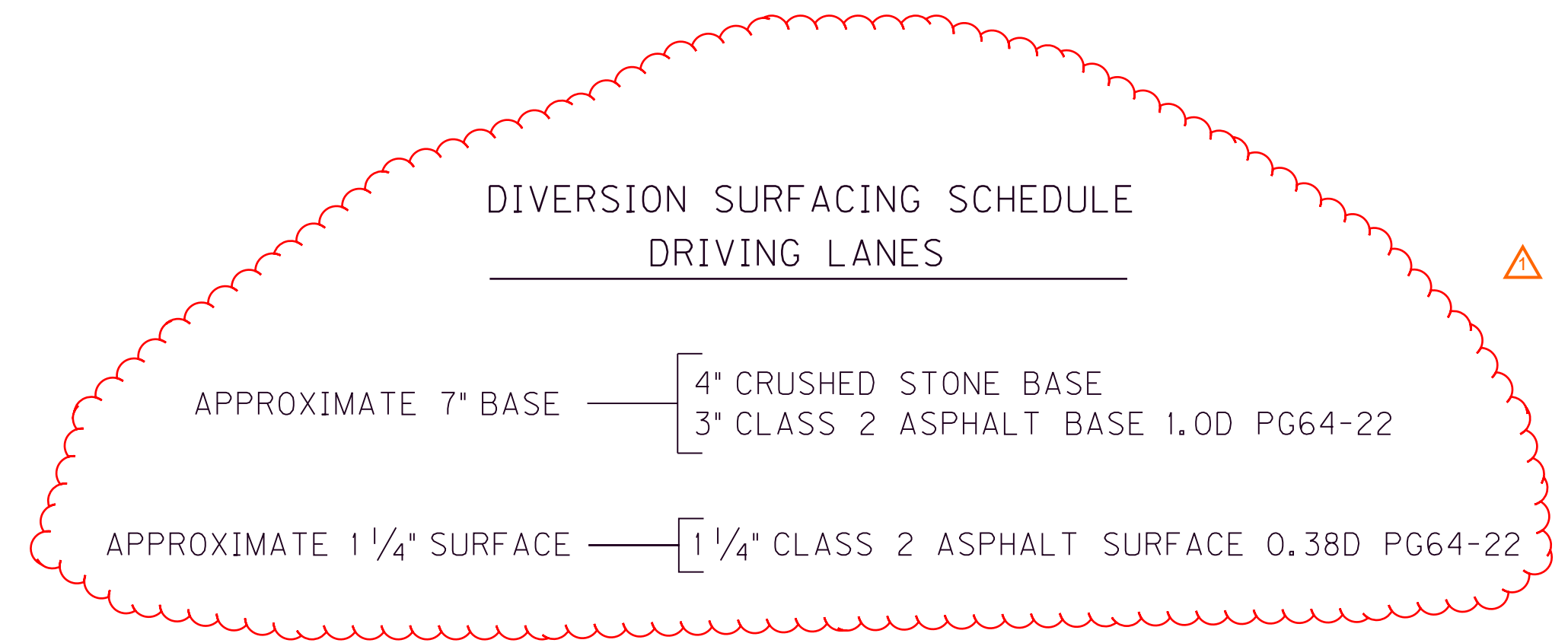

**DETAIL 'D'**

NOT TO SCALE

TYPICAL SECTIONS  
 RAMPS & DIVERSIONS

USER: \$\$\$USER\$\$\$  
 DATE: \$\$\$DATE\$\$\$  
 FILE NAME: \$\$\$designs\$file\$specifications\$\$\$  
 E-SHEET NAME:

DIVERSION #2 LOGSDON PARKWAY			
POINT	STATION	Project Coordinates	
		NORTH (Y)	EAST (X)
POB	10+00.00	2195431.4456	1576706.2564
PC	10+86.42	2195514.3579	1576681.8996
PI	12+06.97	2195630.0196	1576647.9222
PT	13+27.00	2195749.6231	1576632.8522
PC	14+11.24	2195833.2076	1576622.3205
PI	15+27.40	2195948.4566	1576607.7992
PT	16+43.10	2196060.0959	1576575.7075
POE	16+90.00	2196105.1703	1576562.7505

PREPARED BY \_\_\_\_\_ DATE \_\_\_\_\_  
 CHECKED BY \_\_\_\_\_ DATE \_\_\_\_\_  
 APPROVED BY \_\_\_\_\_ DATE \_\_\_\_\_

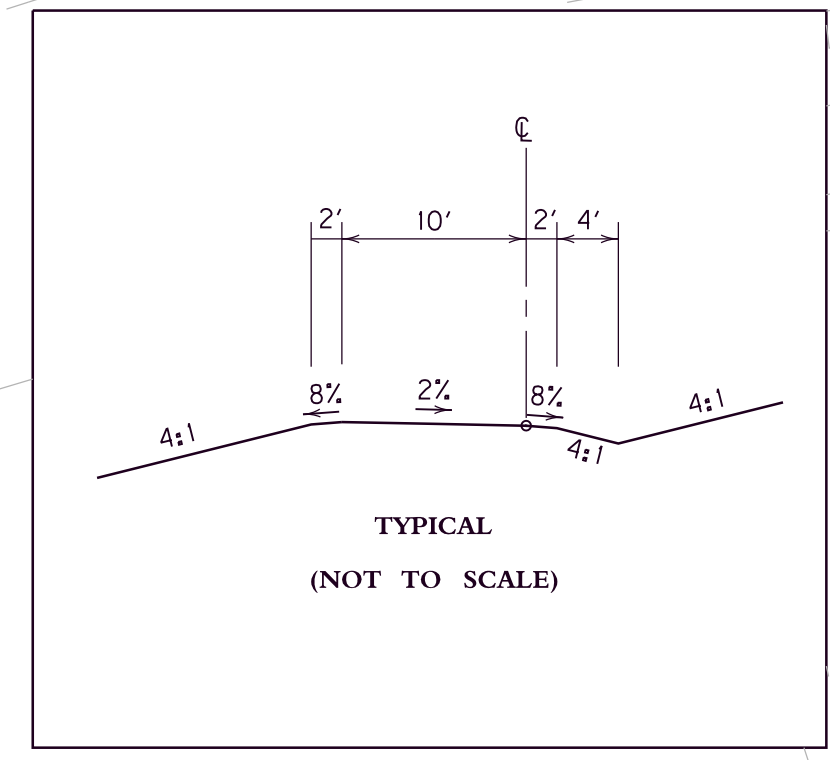

STA. 11+05  
BEGIN DIVERSION #2

STA. 16+15  
END DIVERSION #2

PI 12+06.97  
 $\Delta = 9^\circ 11' 22''$   
 $T = 120.55'$   
 $L = 240.58'$   
 $R = 1500.00'$   
 $E = 4.84'$   
 e= See diagram

PI 15+27.40  
 $\Delta = 8^\circ 51' 23''$   
 $T = 116.16'$   
 $L = 231.86'$   
 $R = 1500.00'$   
 $E = 4.49'$   
 e= See Diagram

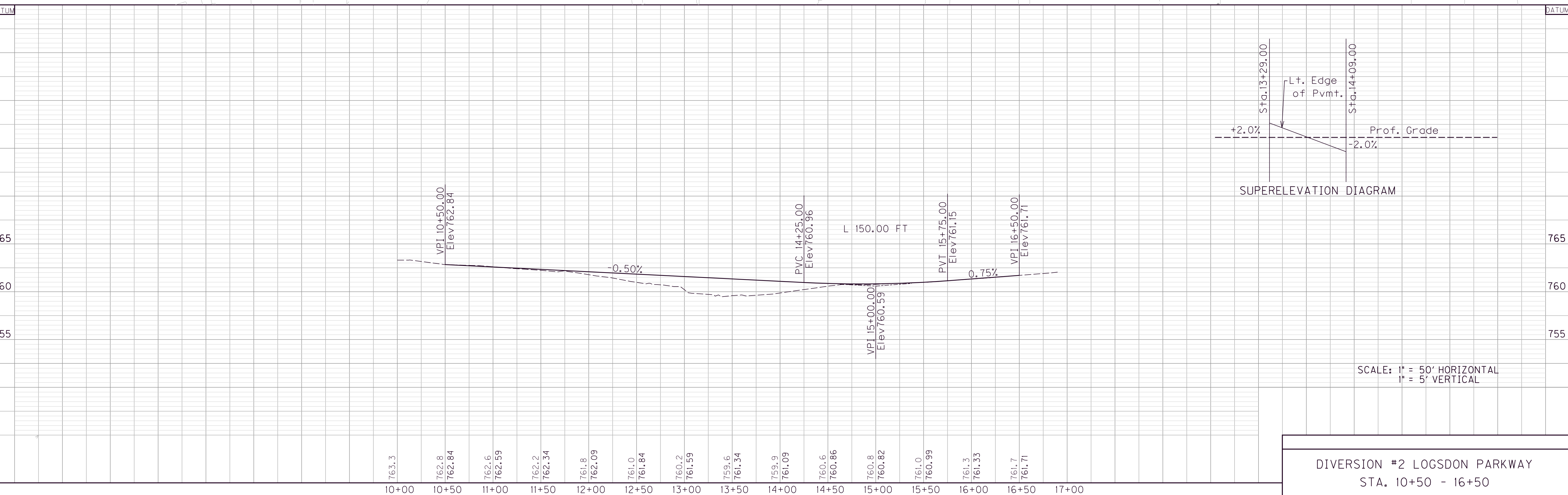

DIVERSION #2 LOGSDON PARKWAY  
 STA. 10+50 - 16+50

USER: \$\$\$USER\$\$\$  
 DATE: \$\$\$DATE\$\$\$  
 FILE NAME: \$\$\$designs\$file\$specifications\$\$\$  
 E-SHEET NAME:



DIVERSION #2 LOGSDON PARKWAY			
POINT	STATION	Project Coordinates	
		NORTH (Y)	EAST (X)
POB	10+00.00	2195431.4456	1576706.2564
PC	10+86.42	2195514.3579	1576681.8996
PI	12+06.97	2195630.0196	1576647.9222
PT	13+27.00	2195749.6231	1576632.8522
PC	14+11.24	2195833.2076	1576622.3205
PI	15+27.40	2195948.4566	1576607.7992
PT	16+43.10	2196060.0959	1576575.7075
POE	16+90.00	2196105.1703	1576562.7505

△ Revised Nov 7, 2011

PREPARED BY \_\_\_\_\_ DATE \_\_\_\_\_  
 CHECKED BY \_\_\_\_\_ DATE \_\_\_\_\_  
 APPROVED BY \_\_\_\_\_ DATE \_\_\_\_\_

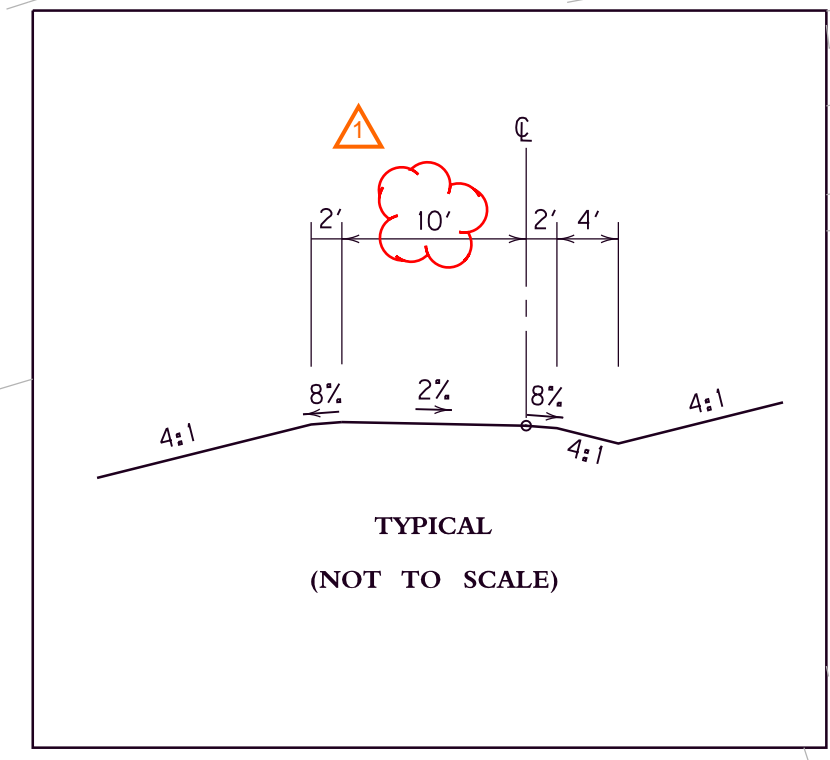

STA. 11+05  
BEGIN DIVERSION #2

STA. 16+15  
END DIVERSION #2

PI 12+06.97  
 $\Delta = 9^\circ 11' 22''$   
 T = 120.55'  
 L = 240.58'  
 R = 1500.00'  
 E = 4.84'  
 e = See diagram

PI 15+27.40  
 $\Delta = 8^\circ 51' 23''$   
 T = 116.16'  
 L = 231.86'  
 R = 1500.00'  
 E = 4.49'  
 e = See Diagram

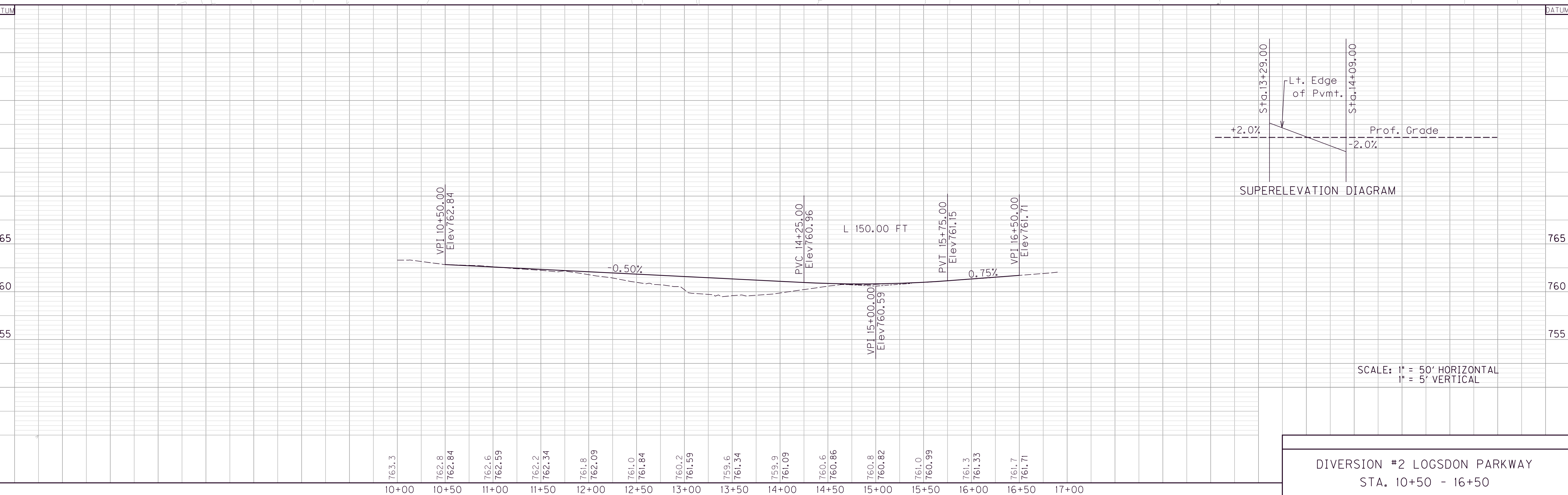

DIVERSION #2 LOGSDON PARKWAY  
 STA. 10+50 - 16+50

USER: \$\$\$USER\$\$\$  
 DATE: \$\$\$DATE\$\$\$  
 FILE NAME: \$\$\$designs\$file\$specifications\$\$\$  
 E-SHEET NAME:

DIVERSION #3 LOGSDON PARKWAY			
POINT	STATION	Project Coordinates	
		NORTH (Y)	EAST (X)
POB	20+00.00	2195441.2772	1576740.7353
PC	20+96.70	2195534.3087	1576714.3371
PI	22+05.65	2195639.1152	1576684.5976
PT	23+14.21	2195738.5246	1576640.0260
PC	24+20.32	2195835.3511	1576596.6125
PI	25+29.26	2195934.7490	1576552.0460
PT	26+37.81	2196039.5430	1576522.3082
POE	26+90.00	2196089.7543	1576508.0595

PREPARED BY \_\_\_\_\_ DATE \_\_\_\_\_  
 CHECKED BY \_\_\_\_\_ DATE \_\_\_\_\_  
 APPROVED BY \_\_\_\_\_ DATE \_\_\_\_\_

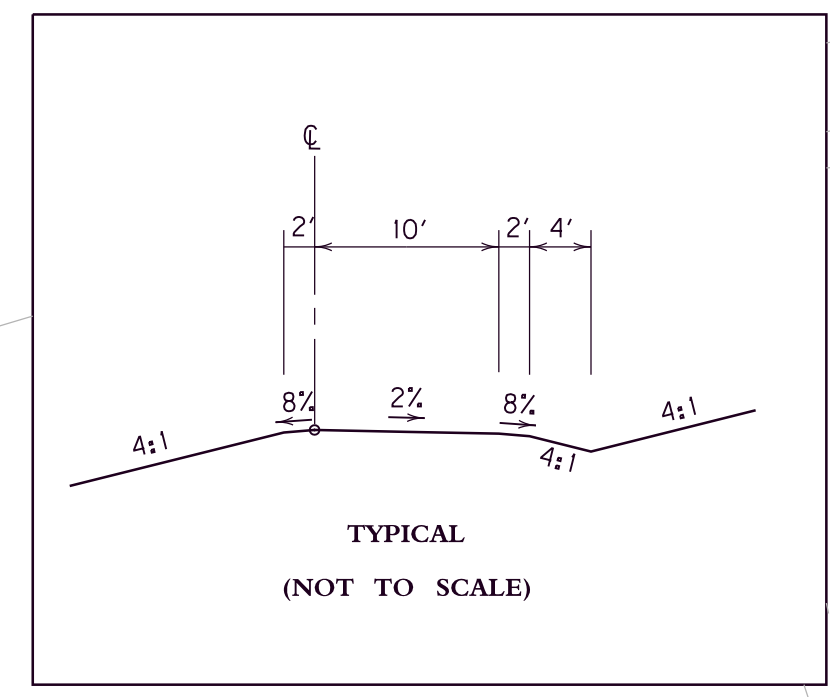

STA. 20+50  
BEGIN DIVERSION #3

STA. 26+50  
END DIVERSION #3

PI 22+05.65  
 $\Delta = 8^\circ 18' 29''$   
 $T = 108.94'$   
 $L = 217.51'$   
 $R = 1500.00'$   
 $E = 3.95'$   
 $e = NA$

PI 25+29.26  
 $\Delta = 8^\circ 18' 26''$   
 $T = 108.93'$   
 $L = 217.48'$   
 $R = 1500.00'$   
 $E = 3.95'$   
 $e = NA$

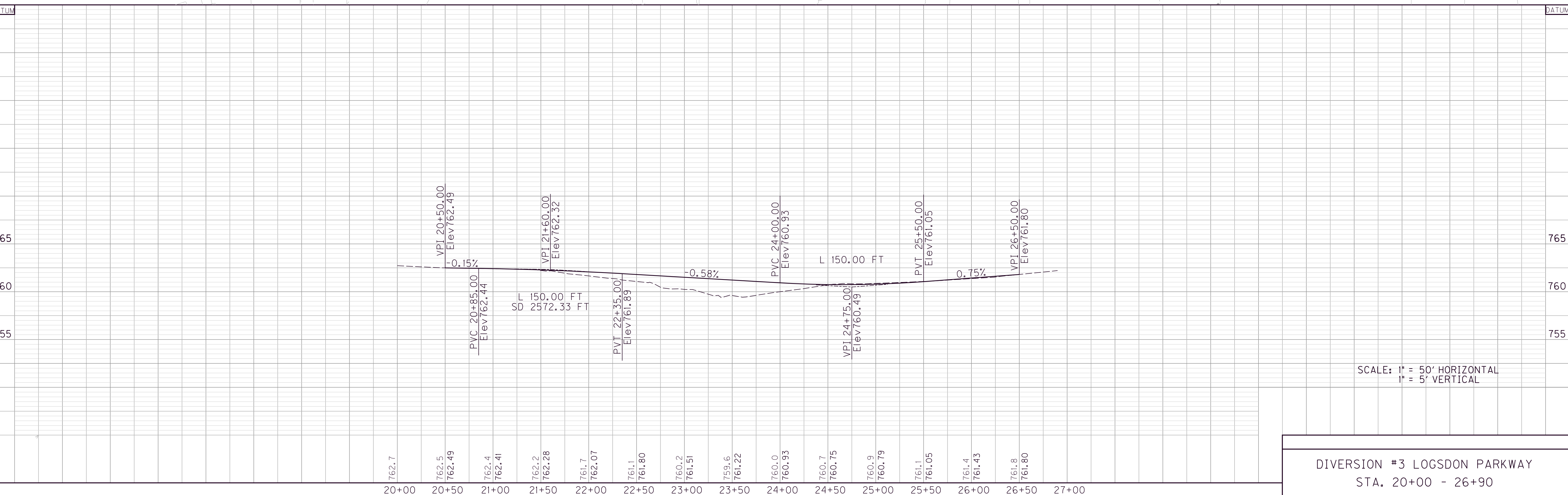

DIVERSION #3 LOGSDON PARKWAY  
 STA. 20+00 - 26+90

USER: \$\$\$USER\$\$\$  
 DATE: \$\$\$DATE\$\$\$  
 FILE NAME: \$\$\$designs\$file\$specifications\$\$\$  
 E-SHEET NAME:



▲ Revised Nov 7, 2011

DIVERSION #3 LOGSDON PARKWAY			
POINT	STATION	Project Coordinates	
		NORTH (Y)	EAST (X)
POB	20+00.00	2195441.2772	1576740.7353
PC	20+96.70	2195534.3087	1576714.3371
PI	22+05.65	2195639.1152	1576684.5976
PT	23+14.21	2195738.5246	1576640.0260
PC	24+20.32	2195835.3511	1576596.6125
PI	25+29.26	2195934.7490	1576552.0460
PT	26+37.81	2196039.5430	1576522.3082
POE	26+90.00	2196089.7543	1576508.0595

PREPARED BY \_\_\_\_\_ DATE \_\_\_\_\_  
 CHECKED BY \_\_\_\_\_ DATE \_\_\_\_\_  
 APPROVED BY \_\_\_\_\_ DATE \_\_\_\_\_

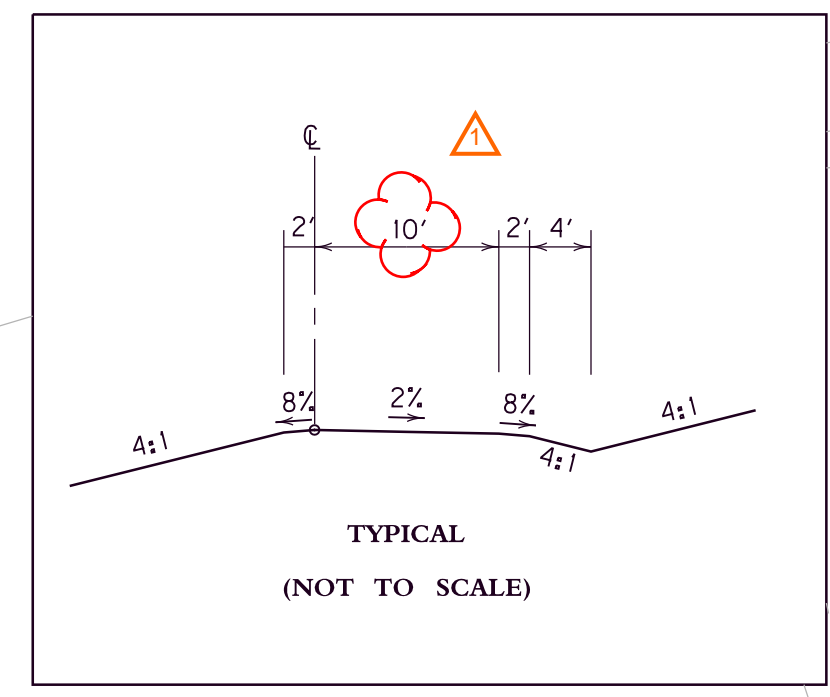

STA. 20+50  
BEGIN DIVERSION #3

STA. 26+50  
END DIVERSION #3

PI 22+05.65  
 $\Delta = 8^\circ 18' 29''$   
 $T = 108.94'$   
 $L = 217.51'$   
 $R = 1500.00'$   
 $E = 3.95'$   
 $e = NA$

PI 25+29.26  
 $\Delta = 8^\circ 18' 26''$   
 $T = 108.93'$   
 $L = 217.48'$   
 $R = 1500.00'$   
 $E = 3.95'$   
 $e = NA$

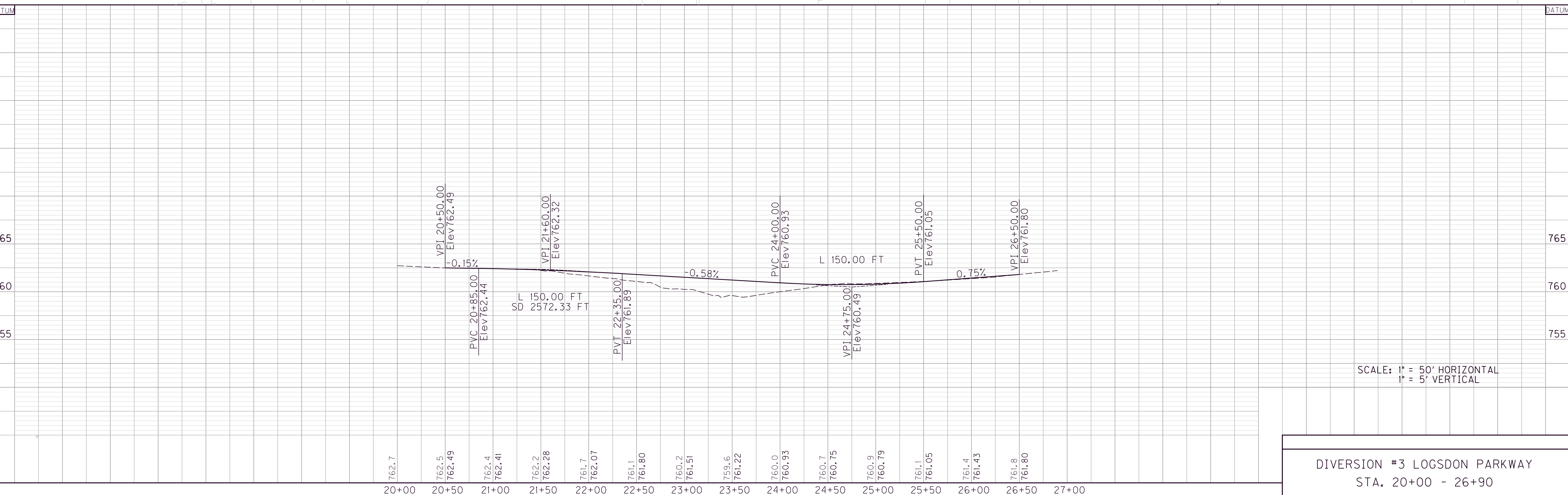

SCALE: 1" = 50' HORIZONTAL  
 1" = 5' VERTICAL

DIVERSION #3 LOGSDON PARKWAY  
 STA. 20+00 - 26+90

USER: \$\$\$USER\$\$\$  
 DATE: \$\$\$DATE\$\$\$  
 FILE NAME: \$\$\$designs\$file\$specifications\$\$\$  
 E-SHEET NAME:



COUNTY OF	ITEM NO.	SHEET NO.
HARDIN	4-8103.50	R34a

PREPARED BY \_\_\_\_\_ DATE \_\_\_\_\_  
 CHECKED BY \_\_\_\_\_ DATE \_\_\_\_\_  
 APPROVED BY \_\_\_\_\_ DATE \_\_\_\_\_

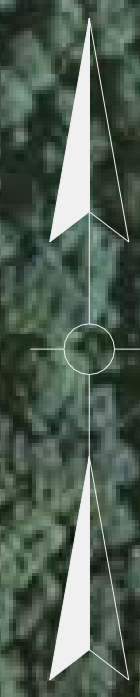

USER: \$\$\$USER\$\$\$  
 DATE: \$\$\$DATE\$\$\$  
 FILE NAME: \$\$\$design\$filespecification\$\$\$  
 E-SHEET NAME: \_\_\_\_\_

APPROX. LIMITS  
 BASE FAILURE  
 REPAIR

BASE FAILURE REPAIR

SCALE: 1" = 100'



Revised Nov 7, 2011

APPROX. M.P. 5.898  
END BASE FAILURE  
REPAIR

APPROX. LIMITS  
BASE FAILURE  
REPAIR

BASE FAILURE REPAIR

SCALE: 1" = 100'

PREPARED BY \_\_\_\_\_ DATE \_\_\_\_\_  
 CHECKED BY \_\_\_\_\_ DATE \_\_\_\_\_  
 APPROVED BY \_\_\_\_\_ DATE \_\_\_\_\_



USER: \$\$\$USER\$\$\$  
 DATE: \$\$\$DATE\$\$\$  
 FILE NAME: \$\$\$design\$filespecification\$\$\$  
 E-SHEET NAME: \_\_\_\_\_





## TABLE OF CONTENTS

PART I	SCOPE OF WORK
	<ul style="list-style-type: none"><li>• PROJECT(S), COMPLETION DATE(S), &amp; LIQUIDATED DAMAGES</li><li>• CONTRACT NOTES</li><li>• STATE CONTRACT NOTES</li><li>• FUEL AND ASPHALT PAY ADJUSTMENT</li><li>• COMPACTION OPTION A</li><li>• SPECIAL NOTE(S) APPLICABLE TO PROJECT</li><li>• WASTE AND BORROW SITES</li><li>• BASE FAILURE REPAIR</li><li>• RIGHT OF WAY NOTES</li><li>• UTILITY CLEARANCE</li><li>• KPDES STORM WATER PERMIT, BMP AND NOI</li><li>• COMMUNICATING ALL PROMISES</li></ul>
PART II	SPECIFICATIONS AND STANDARD DRAWINGS
	<ul style="list-style-type: none"><li>• SPECIFICATIONS REFERENCE</li><li>• SUPPLEMENTAL SPECIFICATIONS</li><li>• [SN-1I] PORTABLE CHANGEABLE SIGNS</li><li>• [SN-11D] ROCK BLASTING</li></ul>
PART III	EMPLOYMENT, WAGE AND RECORD REQUIREMENTS
	<ul style="list-style-type: none"><li>• LABOR AND WAGE REQUIREMENTS</li><li>• EXECUTIVE BRANCH CODE OF ETHICS</li><li>• KENTUCKY EQUAL EMPLOYMENT OPPORTUNITY ACT OF 1978</li><li>• PROJECT WAGE RATES</li></ul>
PART IV	INSURANCE
PART V	BID ITEMS



## **Special Note for Pending Award and Right of Way Clearance**

### **Hardin County, SYP 04-8103.50**

Upon opening of bids, the Department will make the determination to tentatively accept the apparent low bid and proceed with placing the winning bidder for this contract on the Pending Award List. Contrary to Standard Specification 103.02, the Department may hold the award until March 31<sup>st</sup>, 2012 for final disposition of award.

Right-of-Way is anticipated to be clear by March 31, 2012. A meeting will be scheduled with the contractor and the Department no later April 15, 2012. At this meeting, the Contractor and the Department will each be allowed the opportunity to cancel the contract at no cost to either party. If both parties agree, the Pending Award List process can be extended for 30 days, at which time the Contractor and the Department will again be given the opportunity to cancel the contract at no cost to either party. This process can be repeated as long as both parties are willing to accept all original contract bid prices, with appropriate fuel and asphalt adjustments in place at the letting.

Remaining Parcel: Parcel 32 Fort Knox (Sta 354+00 to End of Project)

## Right-of-Way Certification Form

Revised 2/22/11

Federal Funded

Original

State Funded

Re-Certification

This form must be completed and submitted to FHWA with the PS&E package for federal-aid funded Interstate, Appalachia, and Major projects. This form shall also be submitted to FHWA for all federal-aid projects that fall under Conditions No. 2 or 3 outlined elsewhere in this form. When Condition No. 2 or 3 apply, KYTC shall resubmit this ROW Certification prior to construction contract Award. For all other federal-aid projects, this form shall be completed and retained in the KYTC project file.

Date: 28OCT2011

Project Name: KY 1646-KY 313 (New Route)

Letting Date: 18NOV2011

Project #: 13HC JP01 C047 79589 06R

County: Hardin

Item #: 04-8103.50

Federal #: N/A

Description of Project: New Route connecting KY 313 to Boullion Boulevard onto Ft. Knox Military Reservation.

### Projects that require **NO** new or additional right-of-way acquisitions and/or relocations

- The proposed transportation improvement will be built within the existing rights-of-way and there are no properties to be acquired, individuals, families, and businesses ("relocatees") to be relocated, or improvements to be removed as a part of this project.

### Projects that require new or additional right-of-way acquisitions and/or relocations

- Per 23 CFR 635.309, the KYTC hereby certify that all relocatees have been relocated to decent, safe, and sanitary housing or that KYTC has made available to relocatees adequate replacement housing in accordance with the provisions of the current FHWA directive(s) covering the administration of the Highway Relocation Assistance Program and that at least one of the following three conditions has been met. (Check those that apply.)

- Condition 1.** All necessary rights-of-way, including control of access rights when applicable, have been acquired including legal and physical possession. Trial or appeal of cases may be pending in court but legal possession has been obtained. There may be some improvements remaining on the right-of-way, but all occupants have vacated the lands and improvements, and KYTC has physical possession and the rights to remove, salvage, or demolish all improvements and enter on all land. Fair market value has been paid or deposited with the court.

- Condition 2.** Although all necessary rights-of-way have not been fully acquired, the right to occupy and to use all rights-of-way required for the proper execution of the project has been acquired. Trial or appeal of some parcels may be pending in court and on other parcels full legal possession has not been obtained, but right of entry has been obtained, the occupants of all lands and improvements have vacated, and KYTC has physical possession and right to remove, salvage, or demolish all improvements. Fair market value has been paid or deposited with the court for most parcels. Fair market value for all pending parcels will be paid or deposited with the court prior to AWARD of construction contract. (See note 1 below.)

**Note 1:** The KYTC shall re-submit a right-of-way certification form for this project prior to AWARD of all Federal-Aid construction contracts. Award must not to be made until after KYTC has obtained full legal possession and fair market value for all parcels has been paid or deposited with the court and FHWA has concurred in the re-submitted right-of-way certification.



# Right-of-Way Certification Form

Revised 2/22/11

**Condition 3.** The acquisition or right of occupancy and use of a few remaining parcels are not complete and/or some parcels still have occupants. However, all remaining occupants have had replacement housing made available to them in accordance with 49 CFR 24.204. The KYTC is hereby requesting authorization to advertise this project for bids and to proceed with bid letting even though the necessary rights-of-way will not be fully acquired, and/or some occupants will not be relocated, and/or the fair market value will not be paid or deposited with the court for some parcels until after bid letting. KYTC will fully meet all the requirements outlined in 23 CFR 635.309(c)(3) and 49 CFR 24.102(j) and will expedite completion of all acquisitions, relocations, and full payments after bid letting and prior to AWARD of the construction contract or force account construction. A full explanation and reason for this request, including identification of each such parcel and dates on which acquisitions, payments, and relocations will be completed, is attached to this certification form for FHWA concurrence. (See note 2.)

**Note 2:** The KYTC may request authorization on this basis only in unique and unusual circumstances. Proceeding to bid letting shall be the exception and never become the rule. In all cases, the KYTC shall make extraordinary efforts to expedite completion of the acquisition, payment for all affected parcels, and the relocation of all relocatees prior to AWARD of all Federal-Aid construction contracts or force account construction.

\* Designated parcel 032 (USA-Ft. Knox Military Reservation) has not signed any easements for right of way use. This parcel or a portion of this parcel was donated to Kentucky Veterans Affairs for a nursing home and cemetery extension. Approximately 194 acres was donated and it is the responsibility of the Kentucky Veterans Affairs to have the survey completed. I was told by the Corps of Engineers they would not sign any documents until this transaction was completed by Kentucky Veterans Affairs. The area donated is a portion of designated parcel 032 and we will need the new survey in order to establish the land area needed from the new owners. According to the Corps of Engineers this process may take up to 3 months or longer.

Approved: DM Lay \_\_\_\_\_ Right-of-Way Supervisor  
Printed Name Signature

Approved: Keith McDonald \_\_\_\_\_ KYTC, Director of ROW & Utilities  
Printed Name Signature

Approved: \_\_\_\_\_ FHWA, ROW Officer (when applicable)  
Printed Name Signature

# Right-of-Way Certification Form

Revised 2/22/11

Date: 28OCT2011

Project Name: KY 1646-KY 313 (New Route)  
 Project #: 13HC JP01 C047 79589 06R County: Hardin  
 Item #: 04-8103.50 Federal #: N/A  
 Letting Date: 18NOV2011

This project has 46 total number of parcels to be acquired, and 13 total number of individuals or families to be relocated, as well as 5 total number of businesses to be relocated.

- 45 Parcels where acquired by a signed fee simple deed and fair market value has been paid
- 0 Parcels have been acquired by IOJ through condemnation and fair market value has been deposited with the court
- 0 Parcels have not been acquired at this time (explain below for each parcel)
- 0 Parcels have been acquired or have a "right of entry" but fair market value has not been paid or has not been deposited with the court (explain below for each parcel)
- 1 Relocatees have not been relocated from parcels 050, \_\_\_\_\_, \_\_\_\_\_, \_\_\_\_\_, \_\_\_\_\_, \_\_\_\_\_, and \_\_\_\_\_ (explain below for each parcel)

Parcel #	Name/Station	Explanation for delayed acquisition, delayed relocation, or delayed payment of fair market value	Proposed date of payment or of relocation
050	Quesenberry	Has acquired new residence but not moved	15NOV2011
3, 4, 5, 7,	Various	Parcels are out on bid to be demolished	30NOV2011
8, 40, 43,	"	"	30NOV2011
44, 50, 96	"	"	30NOV2011
51, 53, 55	"	"	30NOV2011
032	USA	See above note Page 2 of this certification *	

There are 0 billboards and/or 0 cemeteries involved on this project.

There are 2 water or monitoring wells on parcels 4, 7, \_\_\_\_\_, \_\_\_\_\_, and \_\_\_\_\_. All have been acquired and are the responsibility of the project contractor to close/cap.

**Form Effective Date: April 1, 2006**  
**Last Revised: February 22, 2011**